

30

- 1 ENG. MGR
- 2 ENG PURCH.
- 1 MKTG.
- PLT. MGR.
- COST
- PROD.
- INSP
- GLAZE
- BUSHING
- MAKING
- SHIP
- ASSEM
- MODEL
- MACH.
- 45
- TOOLING
- CER LAB
- 1 EL LAB
- Q. A.

DIMENSIONS

LEAKAGE DISTANCE IN 11

MECHANICAL VALUES

CANTILEVER STRENGTH LB 2,000

ELECTRICAL VALUES

60 HERTZ FLASHOVER-DRY kV 80
 60 HERTZ FLASHOVER-WET kV 55
 IMPULSE FLASHOVER -POS. kV 105
 IMPULSE FLASHOVER -NEG. kV 130

RADIO INFLUENCE VOLTAGE DATA

60 HERTZ TEST VOLTAGE kV 15
 MAXIMUM RIV @ 1000 kHz μ V 50

PACKING INFORMATION

NET WEIGHT , PER 100 LB 1,035
 PACKED WEIGHT ,PER 100 LB 1,110
 NO. IN STANDARD PACKAGE 3

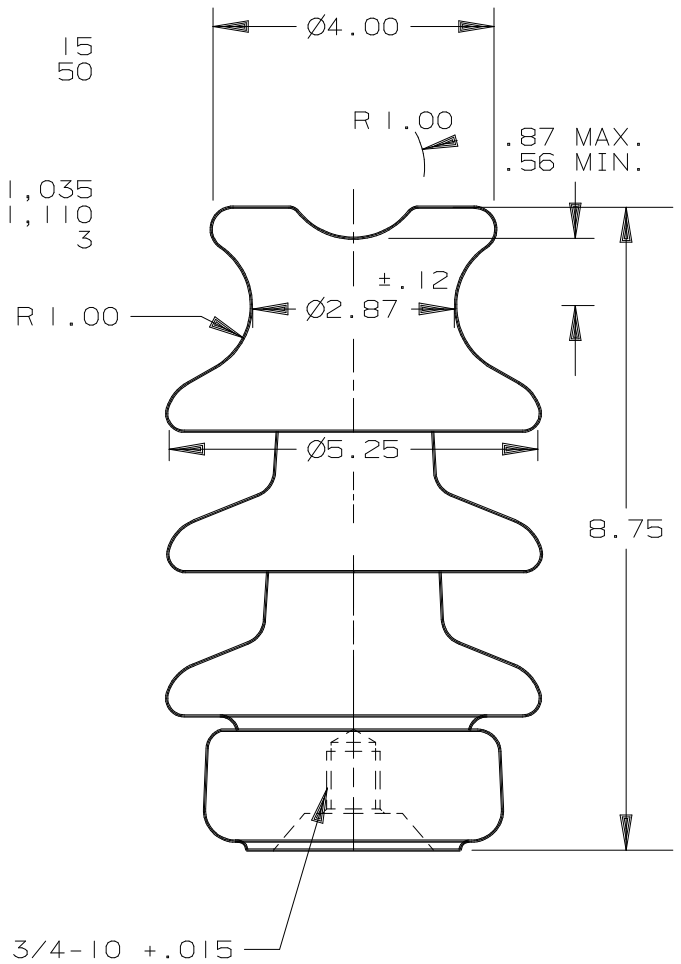

THIS DRAWING IS THE PROPERTY OF VICTOR INSULATORS, INC. AND CONTAINS PROPRIETARY AND CONFIDENTIAL INFORMATION WHICH MUST NOT BE DUPLICATED, USED, OR DISCLOSED OTHER THAN AS EXPRESSLY AUTHORIZED BY VICTOR INSULATORS, INC.

	06-09-00	PP		B
REV'D. PACKING	05-30-00	PP		A
	04-26-00	PPAES		



Victor Insulators, Inc.

280 MAPLE AVENUE
 VICTOR, NEW YORK 14564
 TELEPHONE: (716)924-2127

2120