

30

LINE POST

CAT. NO. 2130

13.2 kV

"C" NECK

- 1 ENG. MGR
- 2 ENG
- PURCH.
- 1 MKTG.
- PLT.MGR.
- COST
- PROD.
- INSP
- GLAZE
- BUSHING
- MAKING
- SHIP
- ASSEM
- MODEL
- MACH.
- 45
- TOOLING
- CER LAB
- 1 EL LAB
- Q. A.

DIMENSIONS

LEAKAGE DISTANCE IN 11
 DRY ARCING DISTANCE IN 5.75

MECHANICAL VALUES

CANTILEVER STRENGTH LB 2,000

ELECTRICAL VALUES

60 HERTZ FLASHOVER-DRY kV 80
 60 HERTZ FLASHOVER-WET kV 55
 IMPULSE FLASHOVER -POS. kV 105
 IMPULSE FLASHOVER -NEG. kV 130

RADIO INFLUENCE VOLTAGE DATA

60 HERTZ TEST VOLTAGE kV 15
 MAXIMUM RIV @ 1000 kHz μ V 50

PACKING INFORMATION

NET WEIGHT ,PER 100 LB 990
 PACKED WEIGHT ,PER 100 LB 1065
 NO. IN STANDARD PACKAGE 3

THIS DRAWING IS THE PROPERTY OF
 VICTOR INSULATORS, INC. AND CONTAINS
 PROPRIETARY AND CONFIDENTIAL INFORMATION
 WHICH MUST NOT BE DUPLICATED, USED,
 OR DISCLOSED OTHER THAN AS EXPRESSLY
 AUTHORIZED BY VICTOR INSULATORS, INC.

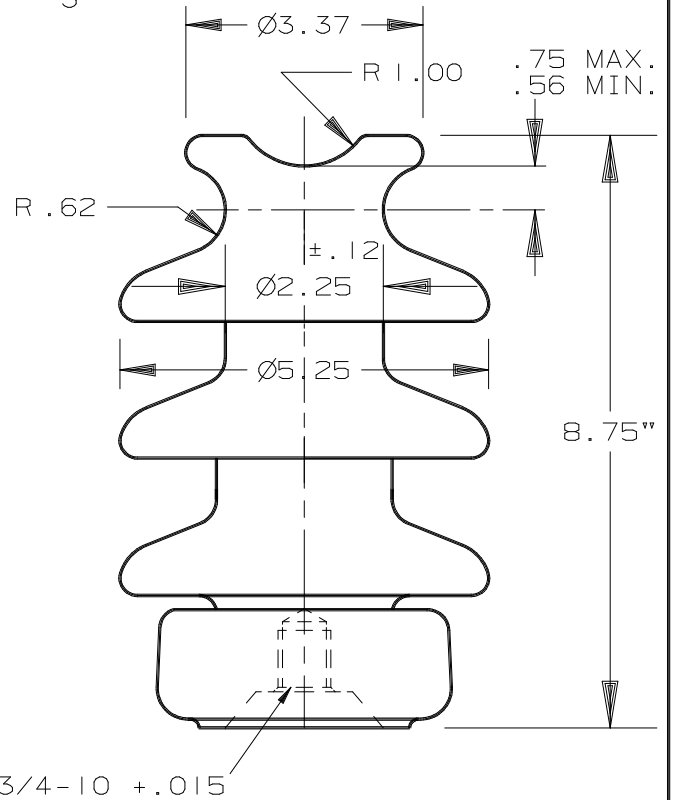

FILE: 2130

REV'D. PACKING	05-30-00	PPAES
	04-26-00	PPAES



Victor Insulators, Inc.

280 MAPLE AVENUE
 MAIL: P.O. BOX B, VICTOR, NEW YORK 14564
 TELEPHONE: (716)924-2127

2130