

19

LOW VOLTAGE PIN TYPE	
CAT. NO. 6R	
F-NECK	1" PINHOLE
ANSI CLASS 55-4	

- 1 ENG. MGR.
- 2 ENG.
- PURCH.
- 1 MKTG.
- PLT. MGR.
- COST
- PROD.
- INSP.
- GLAZE
- BUSHING
- MAKING
- SHIP.
- ASSEM.
- MODEL
- MACH.
- 45
- TOOLING
- CER. LAB.
- 1 EL. LAB.
- 1 E. MEDIA

DIMENSIONS

LEAKAGE DISTANCE	IN	9
DRY ARCING DISTANCE	IN	5
MINIMUM PIN HEIGHT	IN	5

MECHANICAL VALUES

CANTILEVER STRENGTH	LB	3,000
---------------------	----	-------

ELECTRICAL VALUES

IMPULSE FLASHOVER-POS.	kV	105
IMPULSE FLASHOVER-NEG.	kV	130
60 HERTZ FLASHOVER-WET	kV	35
60 HERTZ FLASHOVER-DRY	kV	65
60 HERTZ PUNCTURE VOLTAGE	kV	95

RADIO INFLUENCE VOLTAGE DATA

60 HERTZ TEST VOLTAGE	kV	10
MAXIMUM RIV @ 1000 kHz	μV	50

PACKING INFORMATION

NET WEIGHT PER 100	LB	361
PACKED WEIGHT PER 100	LB	383
NO. IN STANDARD PACKAGE		18

THIS DRAWING IS THE PROPERTY OF VICTOR INSULATORS, INC. AND CONTAINS PROPRIETARY AND CONFIDENTIAL INFORMATION WHICH MUST NOT BE DUPLICATED, USED, OR DISCLOSED OTHER THAN AS EXPRESSLY AUTHORIZED BY VICTOR INSULATORS, INC.

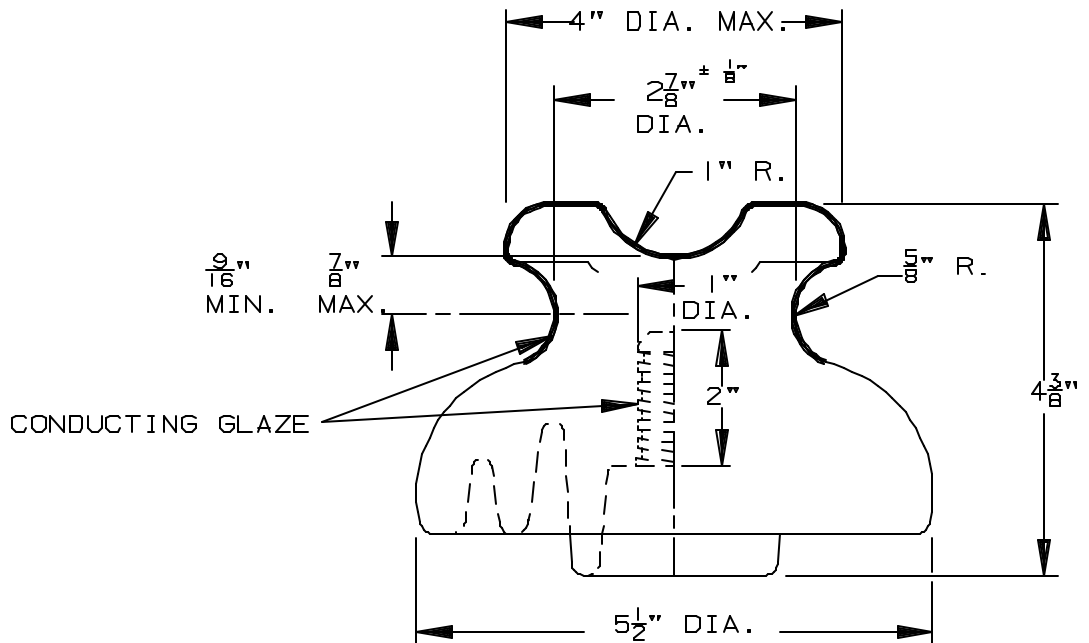

FILE: 6R

10-23-01	TM	PP	AS	B
4-9-92	BA	PP		A

Victor Insulators, Inc.
 280 MAPLE AVENUE
 VICTOR, NEW YORK 14564
 TELEPHONE: (716)924-2127

6R