

30

PIN POST INSULATOR

CAT. NO. 143-143R

F-NECK 1" PINHOLE

25 kV

- 1 ENG. MGR
- 2 ENG
- PURCH.
- 1 MKTG.
- PLT. MGR.
- COST
- PROD.
- INSP
- GLAZE
- BUSHING
- MAKING
- SHIP
- ASSEM
- MODEL
- MACH.
- 45
- TOOLING
- CER LAB
- 1 EL LAB
- Q. A.

DIMENSIONS

LEAKAGE DISTANCE	IN	15.5
DRY ARCING DISTANCE	IN	9
MINIMUM PIN HEIGHT	IN	5

MECHANICAL VALUES

CANTILEVER STRENGTH	LB	3,000
---------------------	----	-------

ELECTRICAL VALUES

60 HERTZ FLASHOVER-DRY	kV	100
60 HERTZ FLASHOVER-WET	kV	70
IMPULSE FLASHOVER-POS.	kV	155
IMPULSE FLASHOVER-NEG.	kV	190
60 HERTZ PUNCTURE VOLTAGE	kV	160

RADIO INFLUENCE VOLTAGE DATA

		TREATED	PLAIN
60 HERTZ TEST VOLTAGE, RMS TO GRD.	kV	20	20
MAXIMUM RIV @ 1000 KHZ	μV	100	10,000

PACKING INFORMATION

NET WEIGHT , PER 100	LB	1,000
PACKED WEIGHT ,PER 100	LB	1,050
NO. IN STANDARD PACKAGE		6

THIS DRAWING IS THE PROPERTY OF
 VICTOR INSULATORS, INC. AND CONTAINS
 PROPRIETARY AND CONFIDENTIAL INFORMATION
 WHICH MUST NOT BE DUPLICATED, USED,
 OR DISCLOSED OTHER THAN AS EXPRESSLY
 AUTHORIZED BY VICTOR INSULATORS, INC.

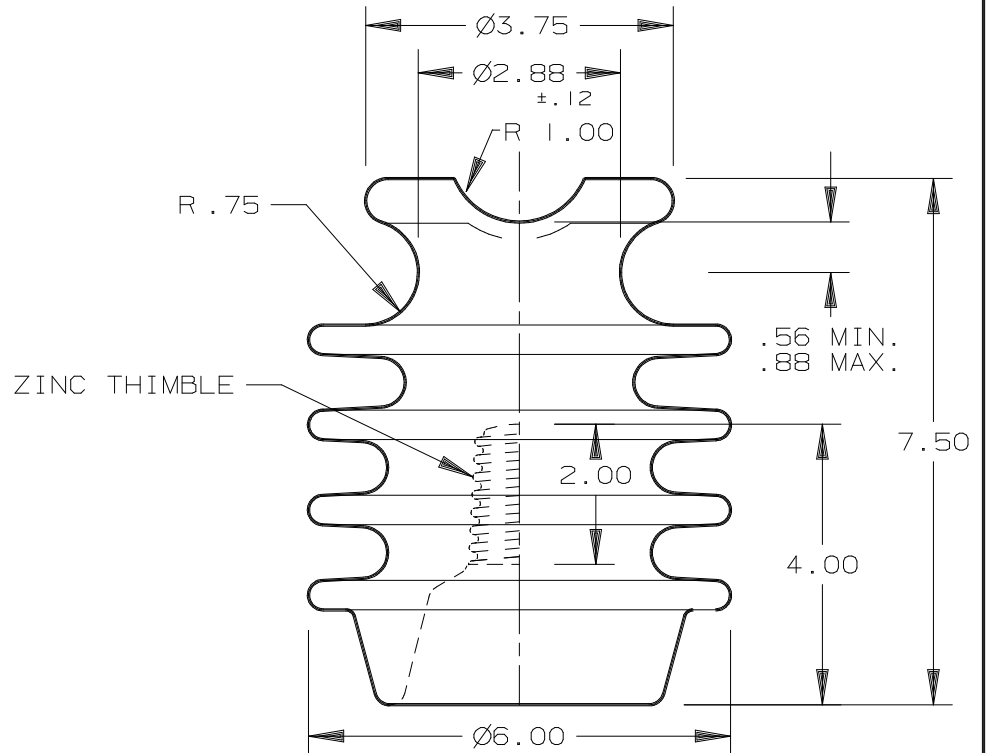

FILE 143-143R



Victor Insulators, Inc.
 280 MAPLE AVENUE
 VICTOR, NEW YORK 14564
 TELEPHONE: (716)924-2127

143-143R

12-12-96

TP PP AS