

30

LINE POST	
CAT. NO. 2120	
13.2 kV	"F" NECK

1 ENG. MGR  
 2 ENG PURCH.  
 1 MKTG.  
 PLT. MGR.  
 COST  
 PROD.  
 INSP  
 GLAZE  
 BUSHING  
 MAKING  
 SHIP  
 ASSEM  
 MODEL  
 MACH.  
 45  
 TOOLING  
 CER LAB  
 EL LAB  
 Q. A.

DIMENSIONS

LEAKAGE DISTANCE IN 11

MECHANICAL VALUES

CANTILEVER STRENGTH LB 2,000

ELECTRICAL VALUES

60 HERTZ FLASHOVER-DRY	kV	80
60 HERTZ FLASHOVER-WET	kV	55
IMPULSE FLASHOVER -POS.	kV	105
IMPULSE FLASHOVER -NEG.	kV	130

RADIO INFLUENCE VOLTAGE DATA

60 HERTZ TEST VOLTAGE	kV	15
MAXIMUM RIV @ 1000 kHz	μV	50

PACKING INFORMATION

NET WEIGHT , PER 100	LB	1,035
PACKED WEIGHT , PER 100	LB	1,110
NO. IN STANDARD PACKAGE		3

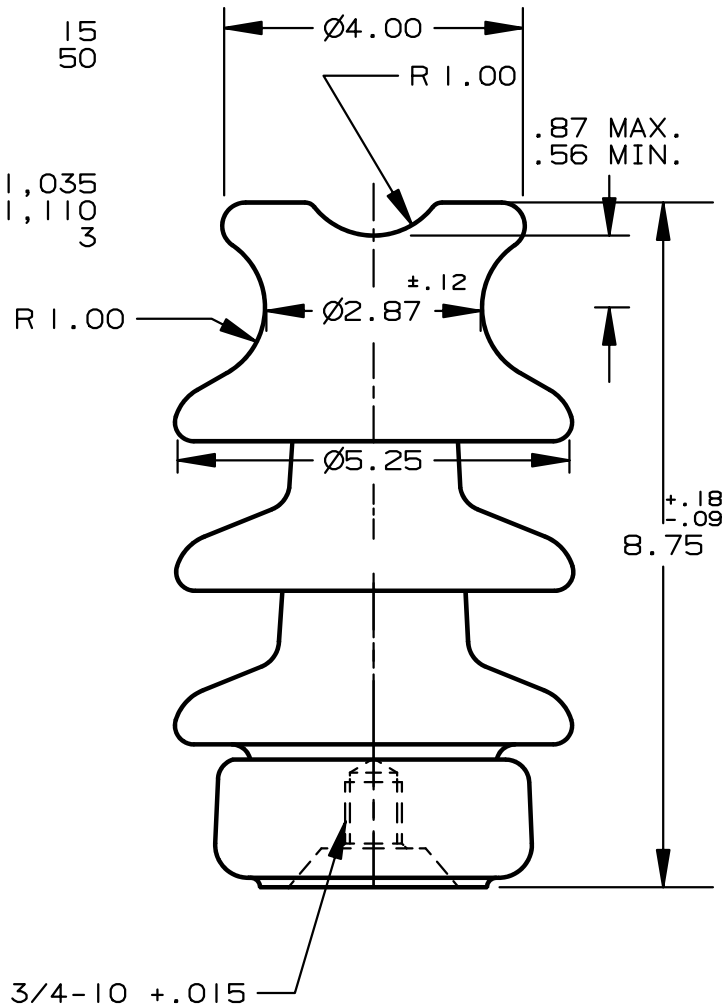

THIS DRAWING IS THE PROPERTY OF VICTOR INSULATORS, INC. AND CONTAINS PROPRIETARY AND CONFIDENTIAL INFORMATION WHICH MUST NOT BE DUPLICATED, USED, OR DISCLOSED OTHER THAN AS EXPRESSLY AUTHORIZED BY VICTOR INSULATORS, INC.

**APPROVED**  
 By A. E. Schwalm at 7:38 am, Feb 11, 2010

CORRECTED GROOVE DIA.	02-10-10	TM	D
REV'D OAL TOLERANCES	05-29-09	TM	C
	06-09-00	PP	B
REV'D. PACKING	05-30-00	PP	A
	04-26-00	PPAES	



**Victor Insulators, Inc.**  
 280 MAPLE AVENUE  
 VICTOR, NEW YORK 14564  
 TELEPHONE: (585)924-2127

2120