

30

LINE POST	
CAT. NO. 2130	
13.2 kV	"C" NECK

1 ENG. MGR  
 2 ENG  
 PURCH.  
 1 MKTG.  
 PLT. MGR.  
 COST  
 PROD.  
 INSP  
 GLAZE  
 BUSHING  
 MAKING  
 SHIP  
 ASSEM  
 MODEL  
 MACH.  
 45  
 TOOLING  
 CER LAB  
 1 EL LAB  
 1 E. MEDIA

DIMENSIONS

LEAKAGE DISTANCE	IN	11
DRY ARCING DISTANCE	IN	5 <sup>3</sup> / <sub>4</sub>

MECHANICAL VALUES

CANTILEVER STRENGTH	LB	2,000
---------------------	----	-------

ELECTRICAL VALUES

60 HERTZ FLASHOVER-DRY	kV	80
60 HERTZ FLASHOVER-WET	kV	55
IMPULSE FLASHOVER -POS.	kV	105
IMPULSE FLASHOVER -NEG.	kV	130

RADIO INFLUENCE VOLTAGE DATA

60 HERTZ TEST VOLTAGE	kV	15
MAXIMUM RIV @ 1000 kHz	μV	50

PACKING INFORMATION

NET WEIGHT , PER 100	LB	990
PACKED WEIGHT , PER 100	LB	1065
NO. IN STANDARD PACKAGE		3

THIS DRAWING IS THE PROPERTY OF VICTOR INSULATORS, INC. AND CONTAINS PROPRIETARY AND CONFIDENTIAL INFORMATION WHICH MUST NOT BE DUPLICATED, USED, OR DISCLOSED OTHER THAN AS EXPRESSLY AUTHORIZED BY VICTOR INSULATORS, INC.

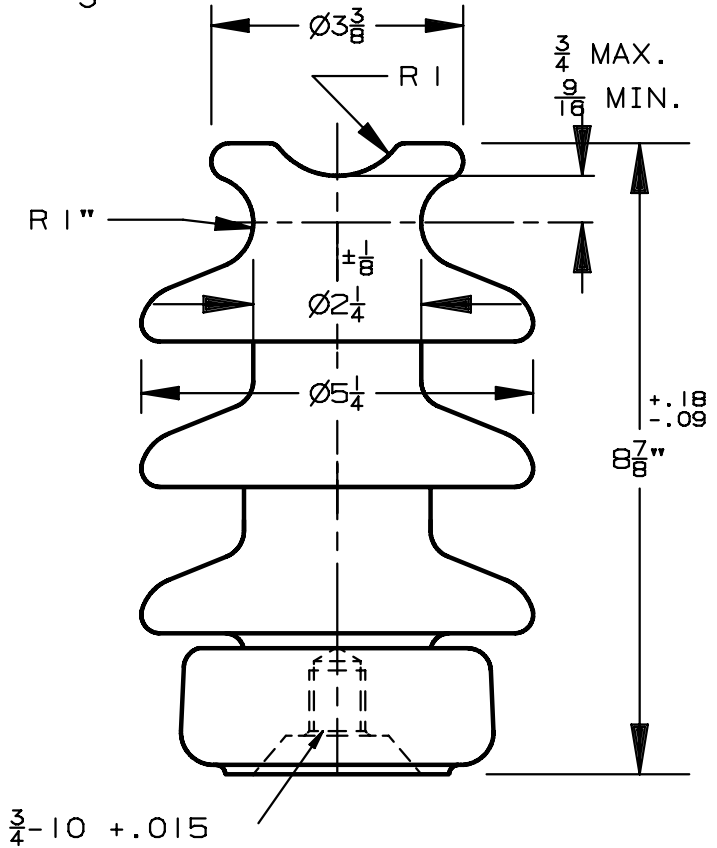

APPROVED  
 By A. E. Schwalm at 12:57 pm, Jun 01, 2009

REV'D OAL TOLERANCE	05-29-09	TM		C
REV'D RADIUS	03-09-09	TM		B
REV'D. PACKING	05-30-00		PP AES	A
	04-26-00		PP AES	



Victor Insulators, Inc.  
 280 MAPLE AVENUE  
 VICTOR, NEW YORK 14564  
 TELEPHONE: (585)924-2127

2130