

POLYMER (SILICONE) INSULATOR

CAT. NO. 8215

15 kV

ANSI CLASS DS-15

DIMENSIONS:

LEAKAGE DISTANCE IN 16 [410 mm]
 DRY ARCING DISTANCE IN 8 [197 mm]

MECHANICAL VALUES:

SPECIFIED MECHANICAL LOAD LB 15,000 [70 kN]
 TORSIONAL LOAD FT-LB 35 [47.5 N-m]

ELECTRICAL VALUES:

60 HERTZ FLASHOVER-DRY kV 90
 60 HERTZ FLASHOVER-WET kV 65
 IMPULSE FLASHOVER-POSITIVE kV 140

RADIO INFLUENCE VOLTAGE DATA:

60 HERTZ TEST VOLTAGE TO GROUND kV 15
 MAXIMUM R.I.V. @ 1000 kHz μ V 10

PACKAGING INFORMATION:

NET WEIGHT, LB 2.6 [1.1 kg]
 PACKED WEIGHT LB 3 [1.3 kg]
 NO. IN STANDARD PACKAGE 18

DIMENSIONS IN [] ARE METRIC.

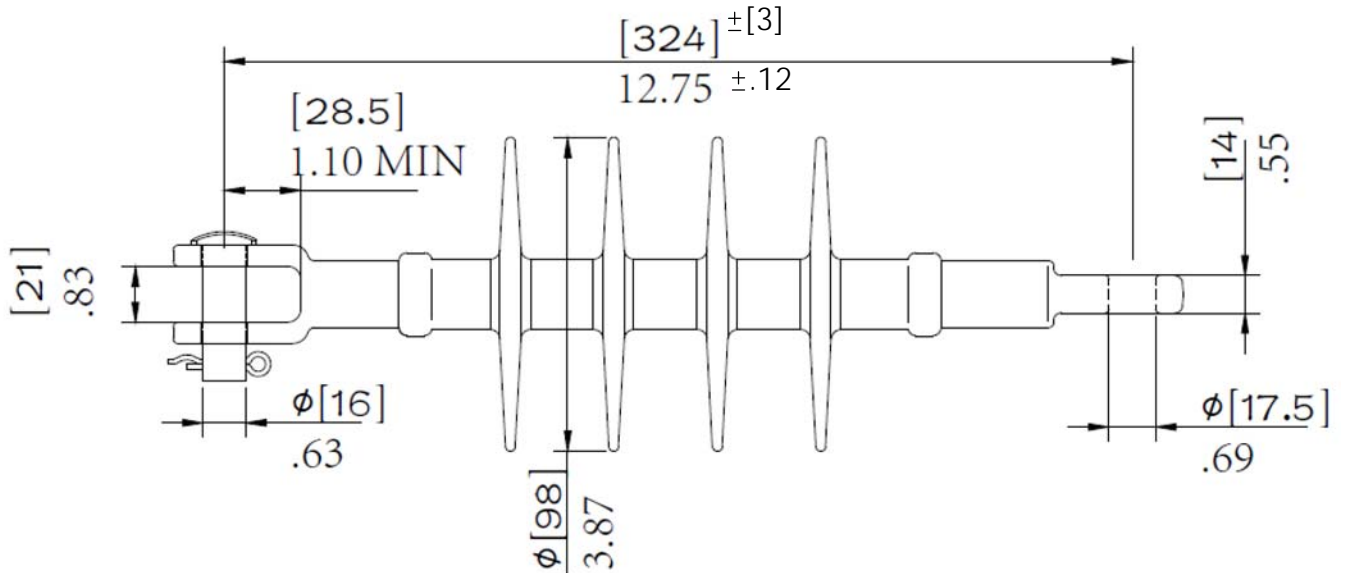

THIS DRAWING IS THE PROPERTY OF VICTOR INSULATORS, INC. AND CONTAINS PROPRIETARY AND CONFIDENTIAL INFORMATION WHICH MUST NOT BE DUPLICATED, USED, OR DISCLOSED OTHER THAN AS EXPRESSLY AUTHORIZED BY VICTOR INSULATORS, INC.

APPROVED
 By A. E. Schwalm at 5:29 pm, Nov 07, 2016

11-07-16	TM	A
04-01-16	TM	



Victor Insulators, Inc.
 280 Maple Avenue
 Victor, New York 14564
 Telephone: (585)924-2127
 www.victorinsulators.com

8215

SUPERSEDES DWG 8215 DATED 02-07-13